

LED FLEX STRIP QUICK CONNECT

Assembly Information

CAUTION!

ONLY FOR MODELS:

FSC-5M-300-12V-W OR ENDING WITH WW, WWX, B, Y, G, R
FSA-5M-300-12V-W OR ENDING WITH WW, B, Y, G, R



WARNING: CONNECTORS ARE RATED FOR A MAXIMUM 3 AMP PER CONNECTOR. INDOOR USE. FOR LOW VOLTAGE USE ONLY 12~24V. PLEASE MAKE SURE THAT THE CORRECT POWER IS USED. THE VOLTAGE IS MARKED ON THE LED FLEXSTRIP. CONTACT A LOCALLY LICENSED ELECTRICIAN FOR INSTALL. INSURE THAT PROPER CURRENT PROTECTION IS IN PLACE (FUSE) AND DOES NOT EXCEED 3 AMPS. FOR USE ONLY WITH CLASS II POWER SUPPLIES. MAXIMUM DISTANCE FROM POWER SUPPLY TO STRIP IS 3 METER (9.85 FEET). NOT FOR THROUGH WALL (OR IN WALL) INSTALLATION. FOR STATIONARY USE ONLY. INDOOR DRY LOCATION USE. DO NOT SUBJECT TO MOVEMENT. CONNECTIONS CAN BE MADE AT ALL MARKED INTERVALS (SCISSOR) ONLY.

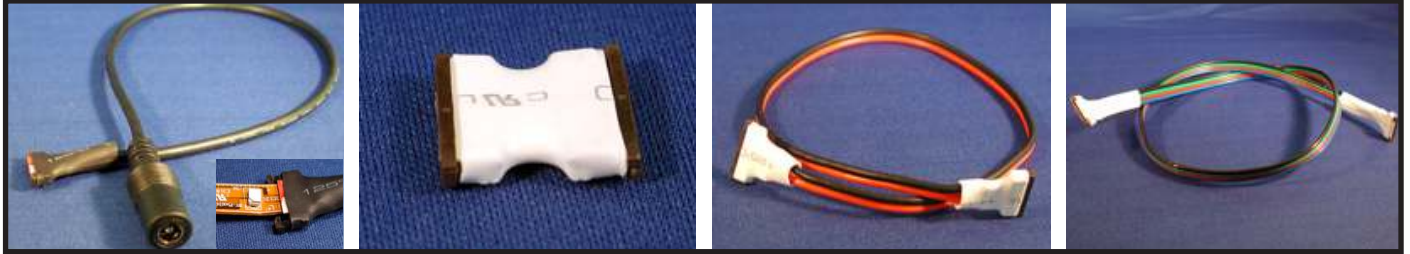

ITEM: SF1D
For connecting to Single color LED Flex Strip to Low Voltage Transformer. Not for use with Type B.

ITEM: SF2 (Single color)
ITEM: MF2 (RGB color 4 wire)
Mini Splice connector. Connect two pieces

ITEM: SF2W
Connect two pieces of LED Flex Strip by wire.

ITEM: MF2W
Connect two pieces of LED RGB Flex Strip with four wire.

Note: for Type B with GEL cover, gently peel back the cover to expose the Flexible printed circuit strip connection points (at scissor marks). For type C Silicone cover, pull the Flexible printed circuit strip out to expose the connection points at scissor marks. Do not damage Flexible printed circuit strip.

IMPORTANT!

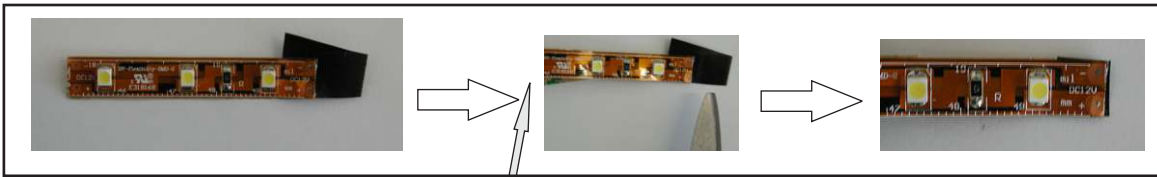

Note: Just before step 2.; on the bottom of the LED Flex Strip (no LED side), place a small piece of electrical tape, about (1/4" x 1/4") and trim to size of to fit the LED strip at the end that will be inserted into the connector. Do not damage the strip when cutting. **This important step helps the LED Flex Strip stay firmly in place** in the connector.

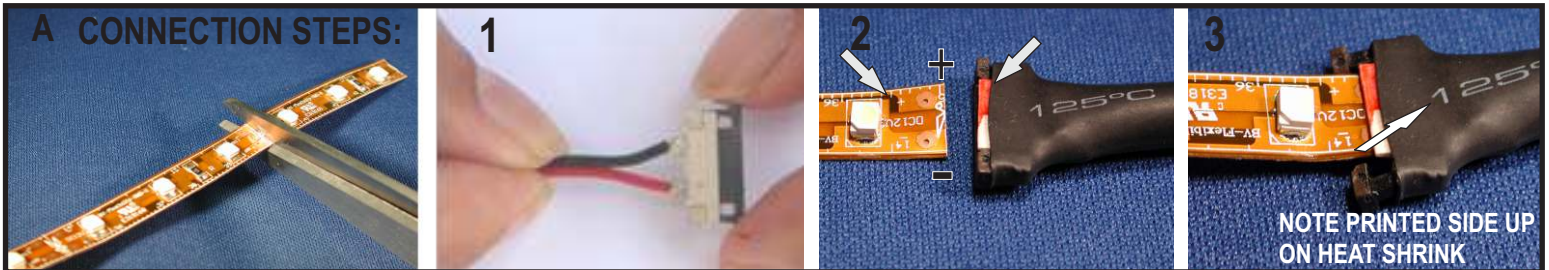

Step A: cut LED Strip only on the marked cut marks (every 3 LEDS for 12v, 6 LEDS for 24V).

Step 1: pull to open connector (black clip).

Step 2: align (+) mark on Flex Strip with the red mark on the connector. If using item SF2W connector, align red wire with (+) mark.

Step 3: insert Flex Strip completely into connector and push black clip to crimp connection. If required, squeeze clip with needle nose pliers to crimp. Gently pull to make sure correct connection has been made and is firmly held. Also, check for correct polarity before powering. + mark is printed on the Strip. **Important! Make sure that the polarity is correctly connected.**

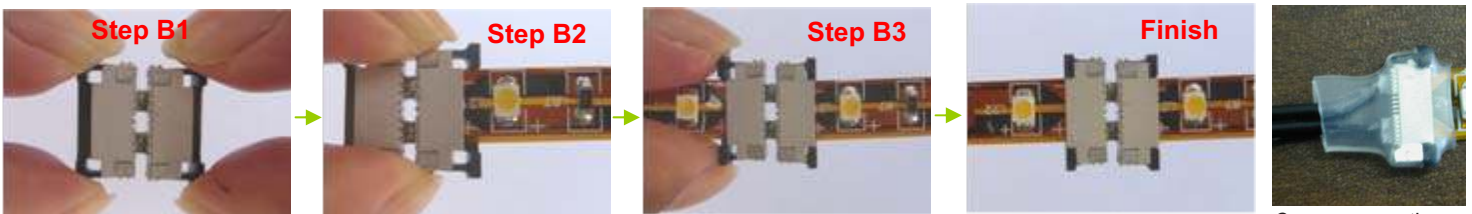

Step B1: pull out the black clip of each side carefully.

Step B2: put the light strip in the space between the clip and connector at one side.

Step B3: put the light strip in the space between the clip and connector at the other side, and pull in the clip at original position.

Important: After connection has been made, check for correct polarity and carefully examine for any possibility of crossover. Next, power the LED Flex Strip. Gently wiggle once to test connection and if the light flickers (not lighting) or the connection comes loose, it has not been done properly and needs to be redone following the above steps. Discard connector after 2 uses. Use according to local safety electrical codes.

When using power supplies; the following basic safety features should be verified in addition to any other application specific concerns and local safety codes:

- Short circuit protection
- Overload protection
- Correct wire type and wire gauge
- Overheat protection